

PRODUCT CARE

- Always store in a dry place and out of the sun.
- Regularly check that the ball, rope and all connections are in good condition.
- Regularly check the composite poles for damage. If damage is observed do not play.
- Dirt and debris inside the score counter can be washed out carefully using a garden hose.

WARNING!

- Failure to comply with any of the warnings in these instructions may result in serious personal injury or property damage.
- Before installation, check for underground power, gas, telephone, water, and other utility lines and pipes. Failure to do so may result in serious or fatal injury.
- Not recommended for children under 6 years of age. Choking hazard – small parts. Use only with mature, knowledgeable supervision. Ensure all safety rules. Keep face and body clear of any moving parts.
- Impact from high velocity balls can cause facial injuries. Entanglement with the rope may cause strangulation and serious injury.

CAUTION

- Before assembly, read these instructions completely. Lay out and identify all components against the parts list below.
- Never hammer the base into the ground. Use foot pressure only, applied directly over the bolts.
- Install on a soft, flat and level playing area. This product is not suitable for paved surfaces. Maintain a safe clearance zone of 15 ft (4.5 m) diameter around the base.
- Use only the included balls and connections. Non-specified accessories may cause damage to the score counter and poles.
- Swing Ball is played using the included tennis ball and paddles.
- Tetherball is played using the included volley ball. Strike the volley ball with your hands, making a fist or with flat palms. Keep fingers away from the ball to avoid injury.
- Do not climb on or pull hard on the poles. Doing so may damage the poles.
- Use only supplied or Viva Active branded parts and accessories. Use of any other kind of accessory is not recommended and may cause injury or damage.

1 ASSEMBLY INSTRUCTIONS: PARTS LIST

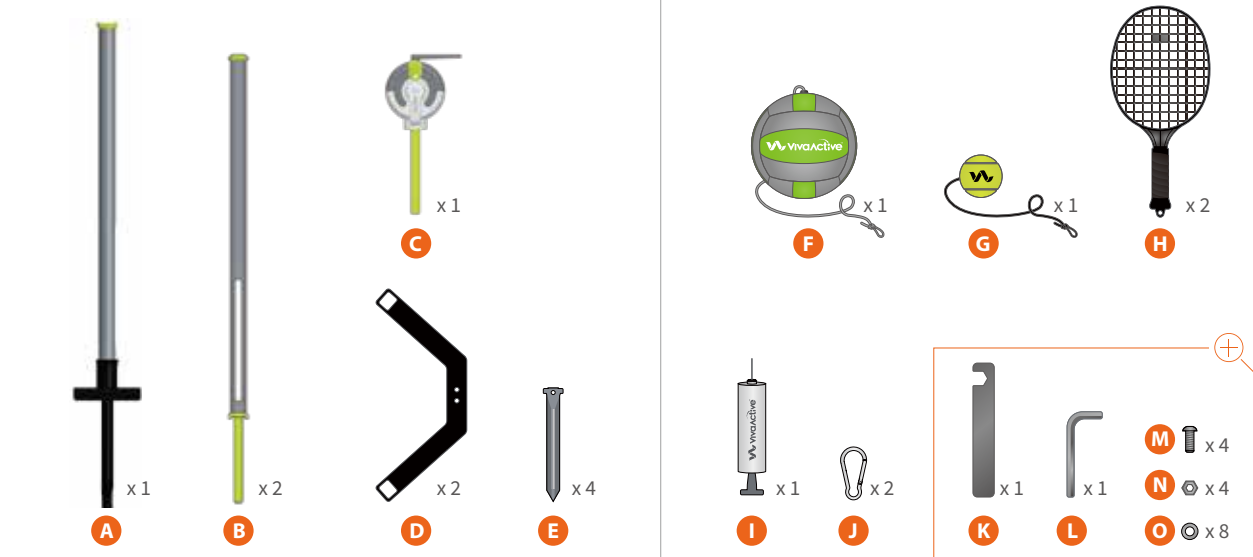

Part	Quantity	Part	Quantity
A. Base Pole	1	I. Pump and needle	1
B. Upper Poles	2	J. Carabiners	2
C. Score Counter	1	K. Wrench	1
D. Anchor Plates	2	L. Hex Key	1
E. Anchor Pegs	4	M. Bolts	4
F. Tetherball volley ball with rope	1	N. Nuts	4
G. Swing Ball tennis ball with rope	1	O. Washers	8
H. Paddles	2		

2 ASSEMBLY INSTRUCTIONS: BASE



- Take the base pole and attach both anchor plates using the bolts, nuts and washers.
TIP – Use the wrench and hex key provided.

3 ASSEMBLY INSTRUCTIONS: BASE

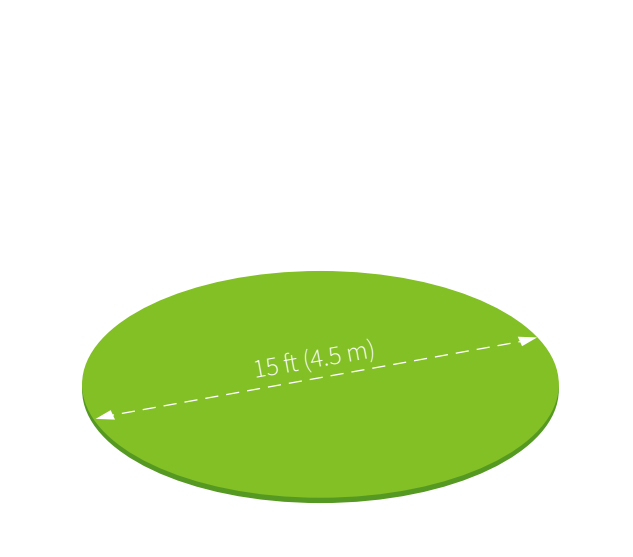

- Find a soft, flat and level playing area. Ensure a safe clearance zone of 15 ft (4.5 m) diameter.
WARNING - Before installation, check for underground power, gas, telephone, water, and other utility lines and pipes. Failure to do so may result in serious or fatal injury.

4 ASSEMBLY INSTRUCTIONS: BASE

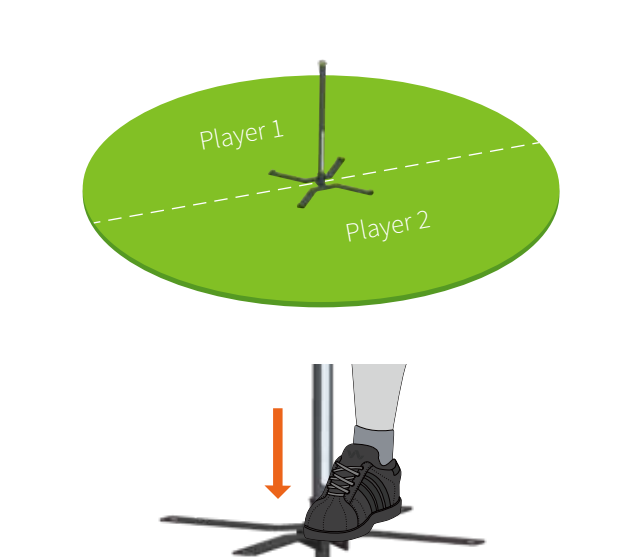

- Secure the spiked end of the base pole into the ground, in the centre of the clearance zone. Use foot pressure only, applied directly over the bolts. Orientate the base as shown to define the area of play.
WARNING - Using a mallet or hammer will damage the base pole.

5 ASSEMBLY INSTRUCTIONS: BASE



- Take one of the anchor pegs and secure it vertically into the ground, through one of the rectangular holes in the anchor plates. Ensure the underside of the peg is flush with the top of the anchor plate.
- Repeat for the other three pegs.
TIP – A rubber mallet may be used to hammer the peg into the ground.

6 ASSEMBLY INSTRUCTIONS: SCORE COUNTER



- Take the score counter and locate it into the top of one of the upper poles.
- Align the tabs and push down on the score counter to clip together.
- Reset the score counter as shown in the 'HOW TO PLAY' section.

7 ASSEMBLY INSTRUCTIONS: BALLS

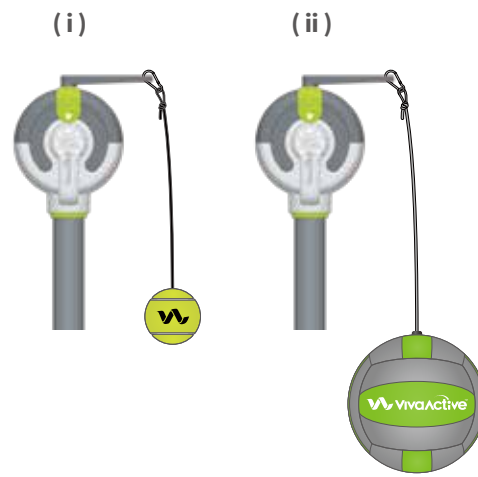

- Attach the desired ball to the score counter arm using one of the included carabiners; feed the carabiner through the loop at the end of the rope, then through the opening in the score counter arm. The following ball options are available:
 - Swing Ball:** tennis ball
 - Tetherball:** volley ball

8 ASSEMBLY INSTRUCTIONS: POLES



- For **Swing Ball**, locate the score counter and upper pole assembly directly into the top of the base pole (i). Align the tabs and push down to clip together.
- For **Tetherball**, locate the score counter and upper pole assembly into the top of the remaining upper pole (ii). Align the tabs and push down to clip together. Now locate this assembly into the top of the base Pole (iii). Align the tabs and push down to clip together.

9 HOW TO PLAY: RESET



- Move both flags on the score counter to the vertical START position; the two triangles will be aligned.
- Flags can be moved by hand, or by spinning the score counter arm.

10 HOW TO PLAY: GAMEPLAY



- Get your flag to the FINISH position to win (either left or right).
- Hitting the ball to your left will move your flag counter-clockwise.
- Hitting the ball to your right will move your flag clockwise.
- One complete revolution of the ball will move your flag one point closer to your finish position while your opponent's flag will move one point away from their finish position.

11 HOW TO PLAY: SHORT GAME



- You can shorten the game by offsetting both flags an even amount toward each player's finish position. The dots are spaced at 5 point increments.

12 HOW TO PLAY: PLAYER ADVANTAGE



- Move a player's flag closer to their finish position before starting the game to give them an advantage, or away from their finish position to give them a disadvantage.

13 HOW TO PLAY: FREE PLAY



- Once the flags have reached the finish point the game can still be played. Great for continuous play or training.

VIVA ACTIVE LIMITED WARRANTY - WHAT IS COVERED

Viva Active and its authorized service partners warrant this product against original defects in material and workmanship for period of 2 years for the poles, 1 year for the plastic parts, and 90 days for the balls, rope and clasp. The warranty period begins from the date of purchase (proof of purchase required). This warranty provides, at no extra cost to you, all parts necessary to ensure your product is in proper working condition throughout the warranty period.

WHAT IS NOT COVERED

This limited warranty is subject to the following terms:

- Viva Active shall not be liable for costs, damages or repairs incurred as a result of:
 - Accessories purchased from an unauthorized dealer.
 - Improper installation not in accordance with the provided assembly instructions.
 - Careless operation or handling, misuse, abuse and/or lack of maintenance or use not in accordance with the provided assembly instructions.
 - External sources such as inclement weather, theft, fire damage or vandalism.
 - Repairs or alterations carried out by unauthorized parties or agents.
 - Use of the product other than for private household purposes. For example, for commercial or rental purposes.

- This limited warranty does not cover misuse or minor imperfections that meet design specifications or do not materially alter functionality.
- This limited warranty does not cover expenses associated with the repair or replacement of covered components.

WARRANTY LIMITATIONS

- Viva Active is not responsible or liable for indirect, special or consequential damages arising out of or in connection with the use or performance of the product or any other damages with respect to any economic loss, loss of property, loss of revenue or profits, loss of enjoyment or use, cost of removal, installation, disassembly or other consequential damages. This limitation is not allowed by some states, provinces or territories and so this limitation may not apply to you.
- Viva Active will not be liable for any consequential damages or incidental damages you may incur in connection with your purchase and use of your product. This limitation is not allowed by some states, provinces, or territories and so this limitation may not apply to you.
- Any implied warranties relating to your product, including but not limited to warranty of merchantability or warranty of fitness for a particular purpose, are limited to the duration of this warranty. This limitation is not allowed by some states, provinces or territories and so this limitation may not apply to you.

- This limited warranty gives you specific legal rights. You may also have other rights which vary by state, province or territory.
- For customers in Australia, our goods come with guarantees that cannot be excluded under the Australian Consumer Law. You are entitled to a replacement or refund for a major failure and compensation for any other reasonably foreseeable loss or damage. You are also entitled to have the goods repaired or replaced if the goods fail to be of acceptable quality and the failure does not amount to a major failure. Goods presented for repair may be replaced by refurbished goods of the same type rather than being repaired. Refurbished parts may be used to repair the goods.
- This limited warranty is not transferable and applies only to the consumer who originally purchased the product.

SUBMITTING YOUR WARRANTY CLAIM

The terms of the limited warranty require that you contact Viva Active with your model name, date and place of purchase and a scan of your purchase receipt. Replacement parts provided under this warranty do not extend the period of the warranty.